



**SCHMIDT
NICHOLS**
LANDSCAPE ARCHITECTURE
AND URBAN PLANNING

1551 N. Flagler Dr, Ste 102
West Palm Beach, FL 33401
Phone: 561.684.6141
Email: info@snlandplan.com
Website: www.snlandplan.com
License No: LC26000232

Blue Heron Commercial

The City of Rivera Beach, Florida

Date: 05/04/21
Scale: 1" = 20'-0"
Design By: MLD
Drawn By: MLD
Checked By: JN
File No. 852.01
Job No. 17-82

REVISIONS / SUBMISSIONS

Landscape Median Plan

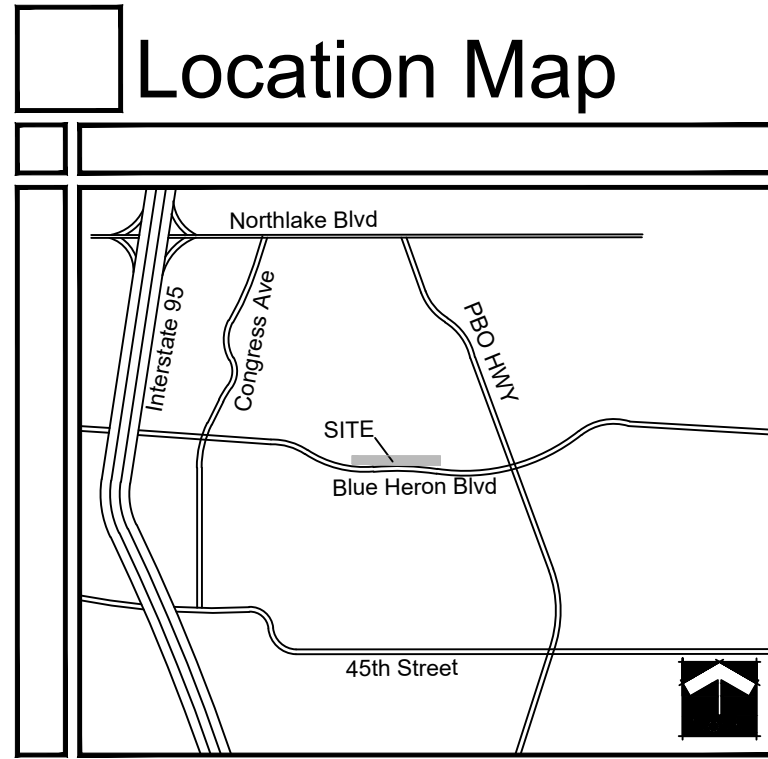

MEDIAN NOTES:
1. All planting in the median shall be installed following FDOT regulations including MOT Regulations.
2. All proposed planting or irrigation modifications proposed in the median shall be permitted and approved by appropriate governing agencies.
3. Developer is responsible for any modifications to the irrigation system required to maintain the proposed planting.
4. Existing plants in the median were not planted by the current applicant or development team and they assume no responsibility for the location or compliance with FDOT regulations.
5. Proposed plantings will be maintained by the Property Owner.

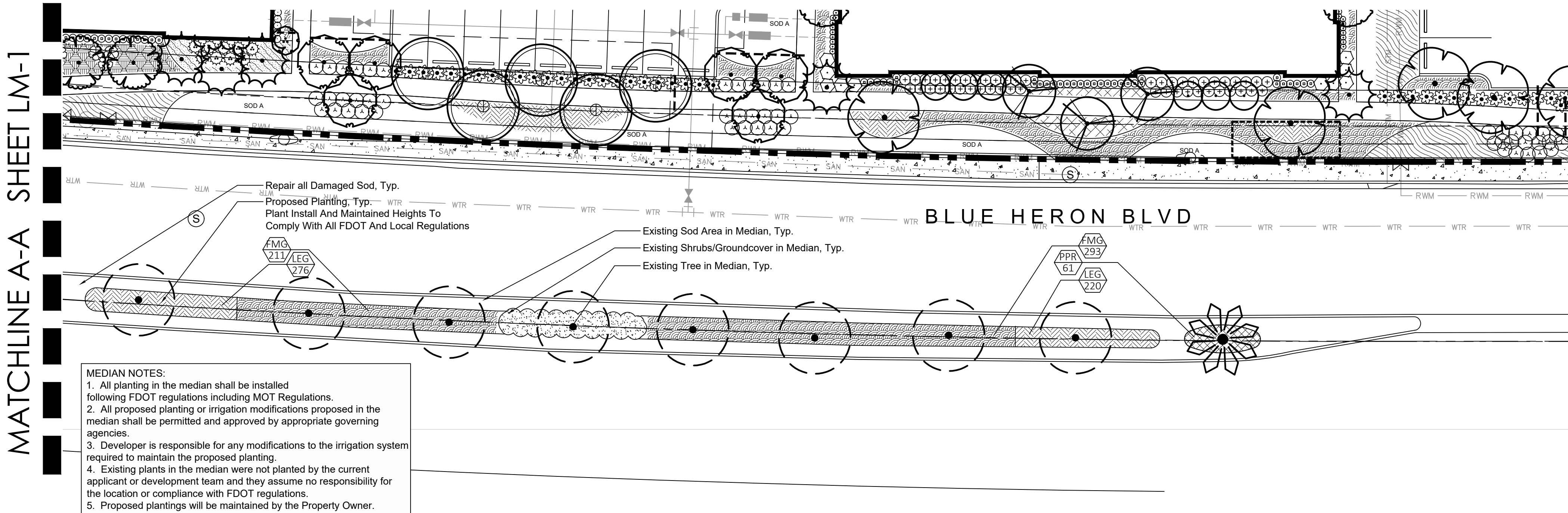
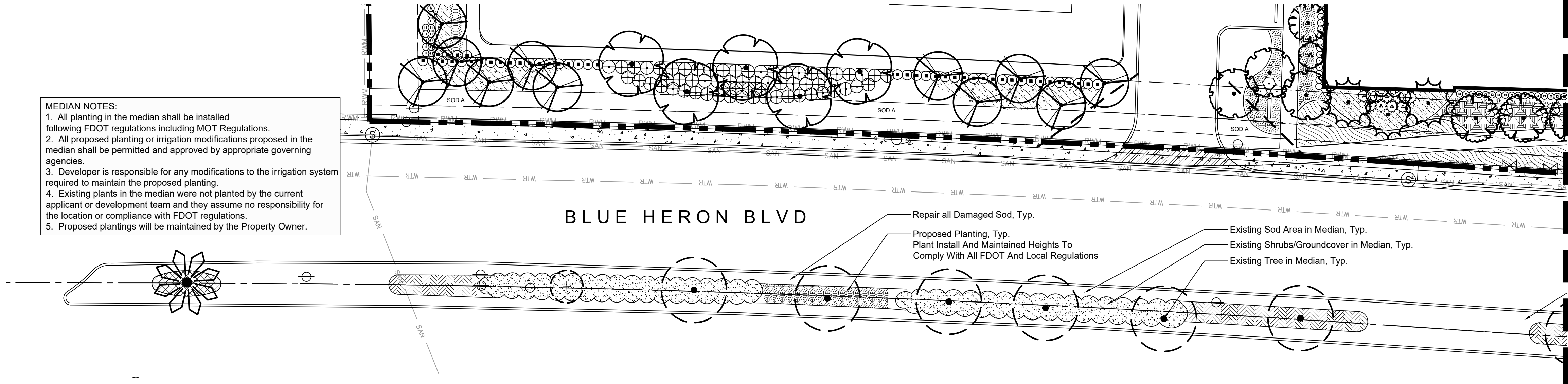

MEDIAN NOTES:
1. All planting in the median shall be installed following FDOT regulations including MOT Regulations.
2. All proposed planting or irrigation modifications proposed in the median shall be permitted and approved by appropriate governing agencies.
3. Developer is responsible for any modifications to the irrigation system required to maintain the proposed planting.
4. Existing plants in the median were not planted by the current applicant or development team and they assume no responsibility for the location or compliance with FDOT regulations.
5. Proposed plantings will be maintained by the Property Owner.

Median Plant List

GROUND COVERS	CODE	QTY	BOTANICAL / COMMON NAME	HEIGHT	SPREAD	SPACING	WATER USAGE	STATUS
	FMG	612	Ficus microcarpa 'Green Island' / Green Island Ficus+ Full to Base	12"	12"	18" O.C.	Medium	Non-Native
	LEG	1,009	Liriope muscari 'Evergreen Giant' / Evergreen Giant Liriope Full	10"-12"	6"	12" O.C.	Low	Non-Native
	PPR	122	Podocarpus macrophyllus 'Pringles' / Dwarf Podocarpus Full +	8"	8"	18" O.C.	Low	Non-Native

SEE SHEET LP-5 FOR ALL PLANTING SPECIFICATIONS



Know what's below.
Call before you dig.

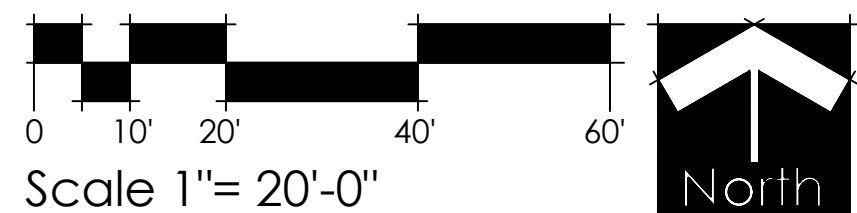

Scale 1" = 20'-0"

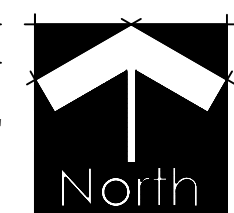

Clear Sight Detail

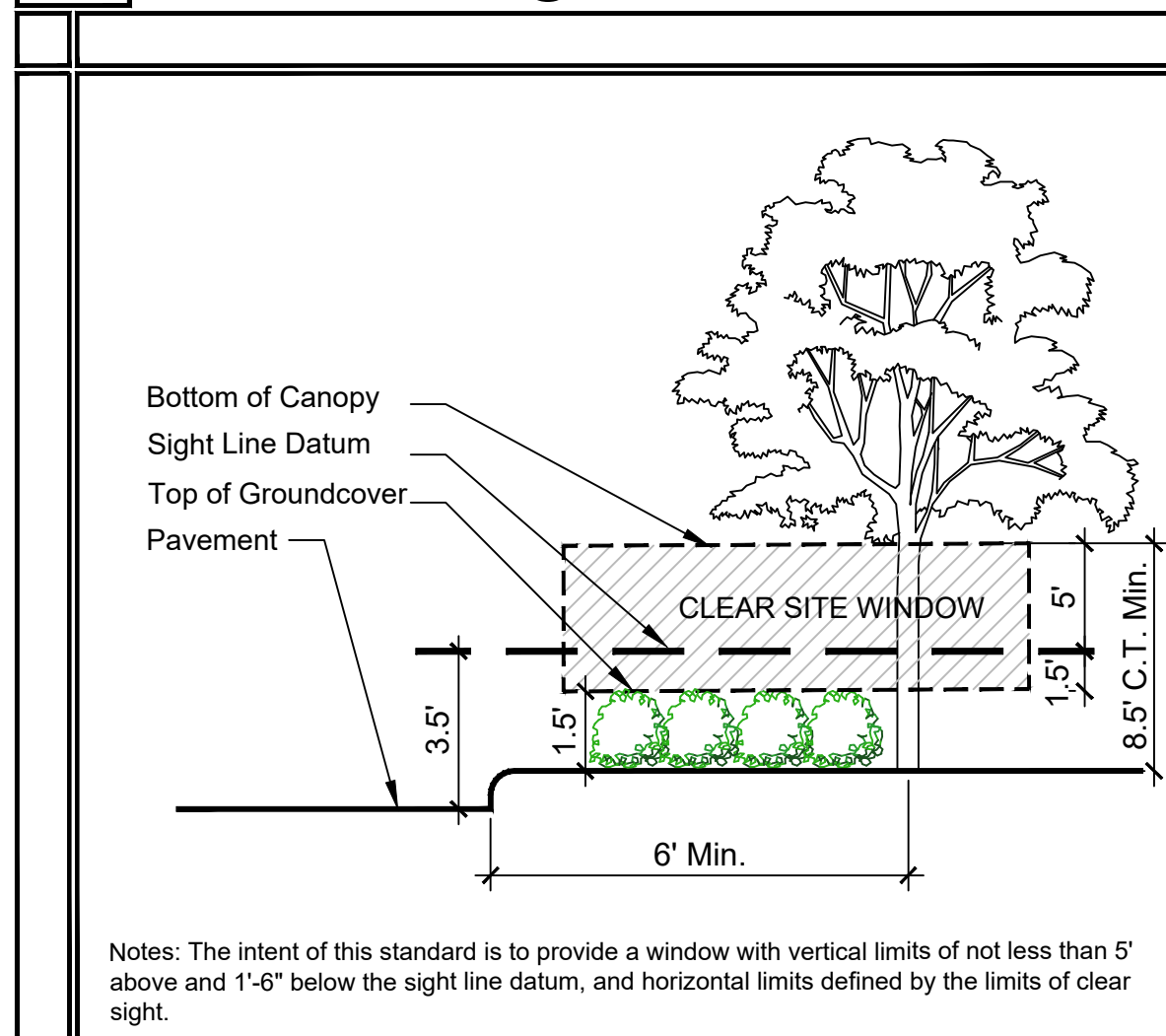

Notes: The intent of this standard is to provide a window with vertical limits of not less than 5' above and 1'-6" below the sight line datum, and horizontal limits defined by the limits of clear sight.

Landscape Notes

2. Landscaping in right-of-way buffers shall be installed on the exterior side of walls or fences.
3. Walls & fences shall be setback a min. of 10' from the ultimate R-O-W.
4. FDOT Type D or F curb shall be provided along the perimeter of all landscape, open space, drainage and grassed areas adjacent to paved vehicular use areas, except where wheel stops are provided.
5. Safe sight triangles shall be maintained clear of vegetation to provide unobstructed visibility between 30" and 8' above crown of road.
6. Light poles, fire hydrants, electrical/mechanical equipment, signs, drainage structures, etc. shall not interfere with landscaping in terminal islands, parking islands, medians, buffers or other landscaped areas.
7. All plant material is to be installed at the height, spread and DBH/Caliper shown in the Plant List, container sizes are given as a suggestion only.
8. No muck-grown sod shall be utilized in detention areas.
9. All landscape areas (including sod) shall be irrigated with an underground automatic sprinkler system providing min. 150% coverage.
10. Trees shown on this plan are for graphic representation only. Tree spacing is based on design requirements and the trees shown on these plans attempt to accomplish that spacing while maintaining the required setbacks from utilities. Trees may be field adjusted to avoid conflicts with driveways and underground utilities. In any case the trees shall be located in the field in accordance with the planting details shown hereon.
11. Trees are to be installed with a ten foot (10') separation from any water or sewer main and/or service, hydrants, and lift stations. If a ten foot (10') separation cannot be achieved, the tree can be installed with a root barrier system. Refer to the "Root Barrier" detail for installation requirements.
12. All planters shall be excavated to a minimum depth of the native soil on site and back-filled with a suitable soil consisting of fifty percent (50%) composted organic matter, well-mixed with native soil. Backfill material shall be free from rock, construction debris, or other extraneous material.