



SCHMIDT NICHOLS
 LANDSCAPE ARCHITECTURE AND URBAN PLANNING

1551 N. Flagler Dr, Ste 102
 West Palm Beach, FL 33401
 Phone: 561.684.6141
 Email: info@snlandplan.com
 Website: www.snlandplan.com
 License No: LC26000232

Blue Heron Commercial

The City of Rivera Beach, Florida

Location Map

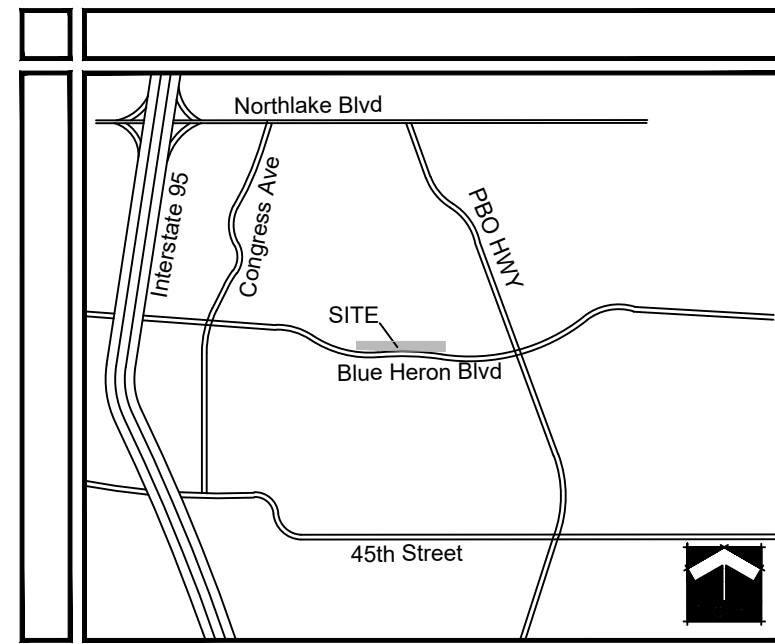

Site Map

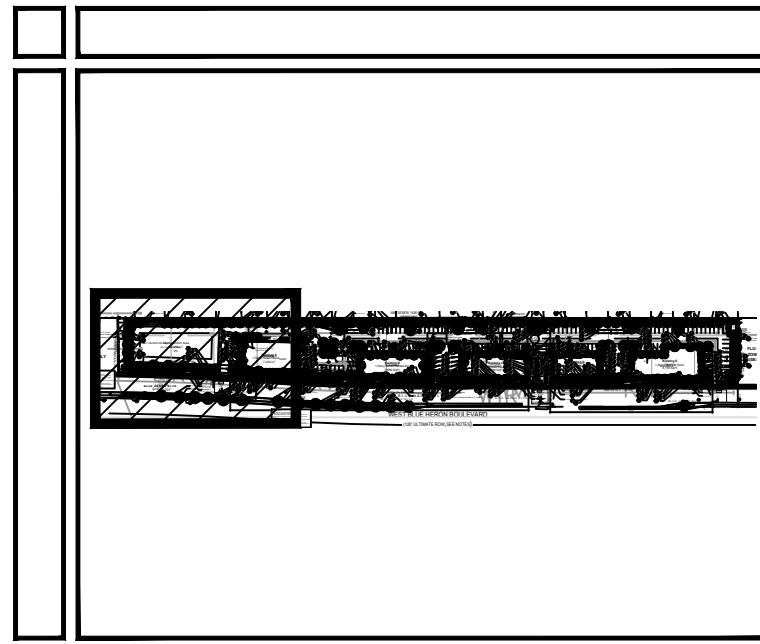

Plant List

| TREES | CODE | QTY | BOTANICAL / COMMON NAME | CALIPER | HEIGHT | SPREAD | CLEAR TRUNK |
|-------|------|--|-------------------------|------------|--------|------------|-------------|
| BO | 2 | Bauhinia x blakeana / Hong Kong Orchid Tree* | 2.5" DBH | 12' | 5' | 6' Min. | |
| BS | 31 | Bursera simaruba / Gumbo Limbo** | 2.5" DBH | 12' | 5' | 6' CT | |
| CL | 36 | Clusia rosea / Autograph Tree** | 2.5" DBH | 12' | 5' | 6' Min. | |
| CE | 6 | Conocarpus erectus / Green Button Wood** | 2.5" DBH | 12' | 5' | 6' Min. | |
| CS | 30 | Conocarpus strictus / Silver Button Wood** | 2.5" DBH | 12' | 5' | 6' Min. | |
| CO | 26 | Cordia sebestena / Orange Ginger Tree** | 1.5" DBH | 10' | 5' | 5' Min. | |
| LI2 | 30 | Lagerstroemia x indica / Natchez Crape Myrtle** | 2.5" DBH | 12' | 5' | 6' Min. | |
| LA | 26 | Lagerstroemia x indica / Azalea Crape Myrtle Multi-Trunk | 1.5" DBH | 10' | 5' | 5' | |
| QV | 16 | Quercus virginiana / Southern Live Oak** | 2.5" DBH | 12' | 5' | 6' Min. | |
| RR | 6 | Roystonia regia / Royal Palm** | N/A | 14' GW | 15' | 14' GW | |
| SP | 28 | Sabal palmetto / Sabal Palm** | N/A | 12'-20' CT | N/A | 12'-20' CT | |
| TH | 10 | Tabebuia heterophylla / Pink Tabebuia** | 2.5" DBH | 12' | 5' | 6' Min. | |
| VM | 15 | Veitchia montgomeryana / Montgomery Palm** | N/A | 12' CT | 12' | 12' CT | |
| VM2 | 22 | Veitchia montgomeryana / Montgomery Palm "Double Trunk" | N/A | 14' CT | 15' | 14' CT | |

| SHRUBS | CODE | QTY | BOTANICAL / COMMON NAME | HEIGHT | SPREAD | SPACING |
|--------|------|---|-------------------------|--------|----------|---------|
| CHC | 110 | Chamaecrista cataractarum / Cat Palm** | 36" | 36" | 48" O.C. | |
| CHI | 371 | Chrysobalanus icaco / Coco Plum** | 24" | 24" | 24" O.C. | |
| CLG | 847 | Clusia guilferia / Small-Leaf Clusia** | 24" | 24" | 24" O.C. | |
| CS3 | 58 | Conocarpus strictus / Silver Button Wood | 36" | 24" | 36" O.C. | |
| CRA | 67 | Crinum augustum / Green Crinum Lily* | 24" | 36" | 48" O.C. | |
| CAQ | 32 | Crinum augustum "Queen Emma" / Queen Emma Crinum Lily | 36" | 36" | 48" O.C. | |
| HRS | 53 | Hibiscus rosa-sinensis "Red" / Red Hibiscus* | 24" | 24" | 48" O.C. | |
| MYF | 121 | Myciathes fragrans / Simpson's Stopper** | 36" | 30" | 24" O.C. | |
| PHI | 63 | Philodendron selloum / Selloum | 36" | 24" | 48" O.C. | |
| PM1 | 127 | Podocarpus macrophylla "Maki" / Maki Podocarpus* | 18" | 12" | 18" O.C. | |
| PM3 | 198 | Podocarpus macrophylla "Maki" / Maki Podocarpus* | 36" | 24" | 24" O.C. | |
| SRG | 23 | Streptocarpus reginae / Orange Bird Of Paradise | 36" | 24" | 48" O.C. | |
| TRF | 330 | Tripsacum floridanum / Dwarf Fakahatchee Grass** | 24" | 24" | 36" O.C. | |

| SHRUB AREAS | CODE | QTY | BOTANICAL / COMMON NAME | HEIGHT | SPREAD | SPACING |
|-------------|-------|---|-------------------------|--------|----------|---------|
| GAG | 158 | Galphimia glauca / Thyrilla** | 18" | 14" | 24" O.C. | |
| HPC | 1,332 | Hamelia patens "Compacta" / Dwarf Firebush** | 18" | 18" | 24" O.C. | |
| JAV | 347 | Jasminum volubile / Wax Jasmine** | 18" | 14" | 18" O.C. | |
| PFB | 169 | Plumbago auriculata "Imperial Blue" / Imperial Blue Plumbago* | 18" | 18" | 18" O.C. | |
| TR2 | 1,605 | Tripsacum floridanum / Dwarf Fakahatchee Grass** | 24" | 18" | 30" O.C. | |

| GROUND COVERS | CODE | QTY | BOTANICAL / COMMON NAME | HEIGHT | SPREAD | SPACING |
|---------------|-----------|---|-------------------------|--------|----------|---------|
| FMG | 1,765 | Ficus microcarpa "Green Island" / Green Island Ficus* | 12" | 12" | 18" O.C. | |
| IVS | 74 | Ilex vomitoria "Schilling's" / Schilling's Holly** | 12" | 12" | 18" O.C. | |
| LEG | 795 | Liriodendron muscari "Evergreen Giant" / Evergreen Giant Liriodendron | 10'-12" | 6" | 12" O.C. | |
| SOD B | 17,644 sf | Paspalum notatum / Bahia Grass | N/A | N/A | N/A | |
| PPR | 810 | Podocarpus macrophylla "Pringles" / Dwarf Podocarpus | 6" | 6" | 18" O.C. | |
| SOD A | 20,611 sf | Sterodaphnum secundatum / St. Augustine Grass | N/A | N/A | N/A | |
| TAM | 3,918 | Trachelospermum asiaticum "Minima" / Minima Jasmine* | 6" | 4" | 14" O.C. | |

Landscape Requirements

| Category | Requirement | No. Required | No. Provided |
|---------------------|-------------|---------------|--------------|
| Trees: | | | |
| North Property Line | 1438' | 20 I.F. | 72 |
| South Property Line | 1437' | 20 I.F. | 72 |
| East Property Line | 155' | 8 I.F. | 8 |
| West Property Line | 129' | 7 I.F. | 7 |
| TOTAL BUFFER TREES | | 159 | 159 |
| Hedge: | | | |
| North Property Line | 1438' | Hedge | 717 |
| East Property Line | 155' | Hedge | 71 |
| West Property Line | 129' | Hedge | 59 |
| TOTAL HEDGE | | 847 | 847 |
| South ROW: | | | |
| Large Shrubs | 1437' | 48" o.c. Max. | 360 |
| Medium Shrubs | 1437' | 48" o.c. Max. | 360 |
| Small Shrubs | 1437' | 24" o.c. Max. | 719 |
| Groundcover | 1437' | 6" o.c. Max. | 2874 |
| TOTAL GROUND COVER | | 4313 | 4333 |

| Category | Requirement | No. Required | No. Provided |
|---|-----------------|---------------|--------------|
| Landscape Area (Net Site: 195,007 sf)* | 20% Site | 39,001 sf | 65,918 sf |
| Add. Landscape Area (11 Addt. Parking Spaces) | 10 sf / Space | 110 sf | 110 sf |
| TOTAL LANDSCAPE AREA | | 39,111 sf | 65,918 sf |
| Sod Area (39,111 sf Landscape Area) | 50% Max. | 19,556 sf Max | 18,817 sf |
| Interior Landscape Area (Total Required: 39,111 sf) | 50% of Required | 19,556 sf | 19,598 sf |

| Category | Requirement | No. Required | No. Provided |
|---|-------------|--------------|--------------|
| Terminal Island Trees (38 Islands) | 1/Island | 38 | 38 |
| Interior Island Trees (7 Islands) | 1/Island | 7 | 7 |
| Foundation Trees (Adjacent to VUA only) | | | |
| Building A (243 If) | 1/20 If | 12 | 12 |
| Building B (232 If) | 1/20 If | 12 | 12 |
| Building C (191 If) | 1/20 If | 10 | 10 |
| Building D (238 If) | 1/20 If | 12 | 12 |
| Building E (282 If) | 1/20 If | 14 | 14 |
| TOTAL INTERIOR TREES | | 105 | 105 |

| Category | Requirement | No. Required | No. Provided |
|--|-------------|--------------|--------------|
| Overall Site Trees (Net Site: 195,007 sf)* | 1/1500 sf | 131 | 131 |

| Category | Requirement | No. Required | No. Provided |
|--|--------------------|--------------|--------------|
| Native Shade Trees (264 Trees Required) | 60% | 158 | 237 |
| Native Accent Trees (264 Trees Required) | 10% | 26 | 26 |
| Overall Native Plant Material | 70% | 3887 | 4883 |
| Palm Trees (264 Trees Required) | 20% Max. | 52 | 52+ |
| Tree Species Variation | 65% Max. 1 Species | 172 Max. | 39 Max. |
| Shade Tree Species Mx | 6 species | 6 | 11 |

* Site Area 213,900 sf
 Less out Detention -18,893 sf
 Net Site Area 195,007 sf
 + Additional 14 Above Code
 Max. not Counted for Credit

Landscape Notes

- Landscaping in right-of-way buffers shall be installed on the exterior side of walls or fences.
- Walls & fences shall be setback a min. of 10' from the ultimate R-O-W.
- FDOT Type D or F curb shall be provided along the perimeter of all landscape, open space, drainage and grassed areas adjacent to paved vehicular use areas, except where wheel stops are provided.
- Safe sight triangles shall be maintained clear of vegetation to provide unobstructed visibility between 30" and 8' above crown of road.
- Light poles, fire hydrants, electrical/mechanical equipment, signs, drainage structures, etc. shall not interfere with landscaping in terminal islands, parking islands, medians, buffers or other landscaped areas.
- All plant material is to be installed at the height, spread and DBH/Caliper shown in the Plant List, container sizes are given as a suggestion only.
- No muck-grown sod shall be utilized in detention areas.
- All landscape areas (including sod) shall be irrigated with an underground automatic sprinkler system providing min. 150% coverage.
- Trees shown on this plan are for graphic representation only. Tree spacing is based on design requirements and the trees shown on these plans attempt to accomplish that spacing while maintaining the required setbacks from utilities. Trees may be field adjusted to avoid conflicts with driveways and underground utilities. In any case the trees shall be located in the field in accordance with the planting details shown hereon.
- Trees are to be installed with a ten foot (10') separation from any water or sewer main and/or service, hydrants, and lift stations. If a ten foot (10') separation cannot be achieved, the tree can be installed with a root barrier system. Refer to the "Root Barrier" detail for installation requirements.
- All planters shall be excavated to a minimum depth of the native soil on site and back-filled with a suitable soil consisting of fifty percent (50%) composted organic matter, well-mixed with native soil. Backfill material shall be free from rock, construction debris, or other extraneous material.

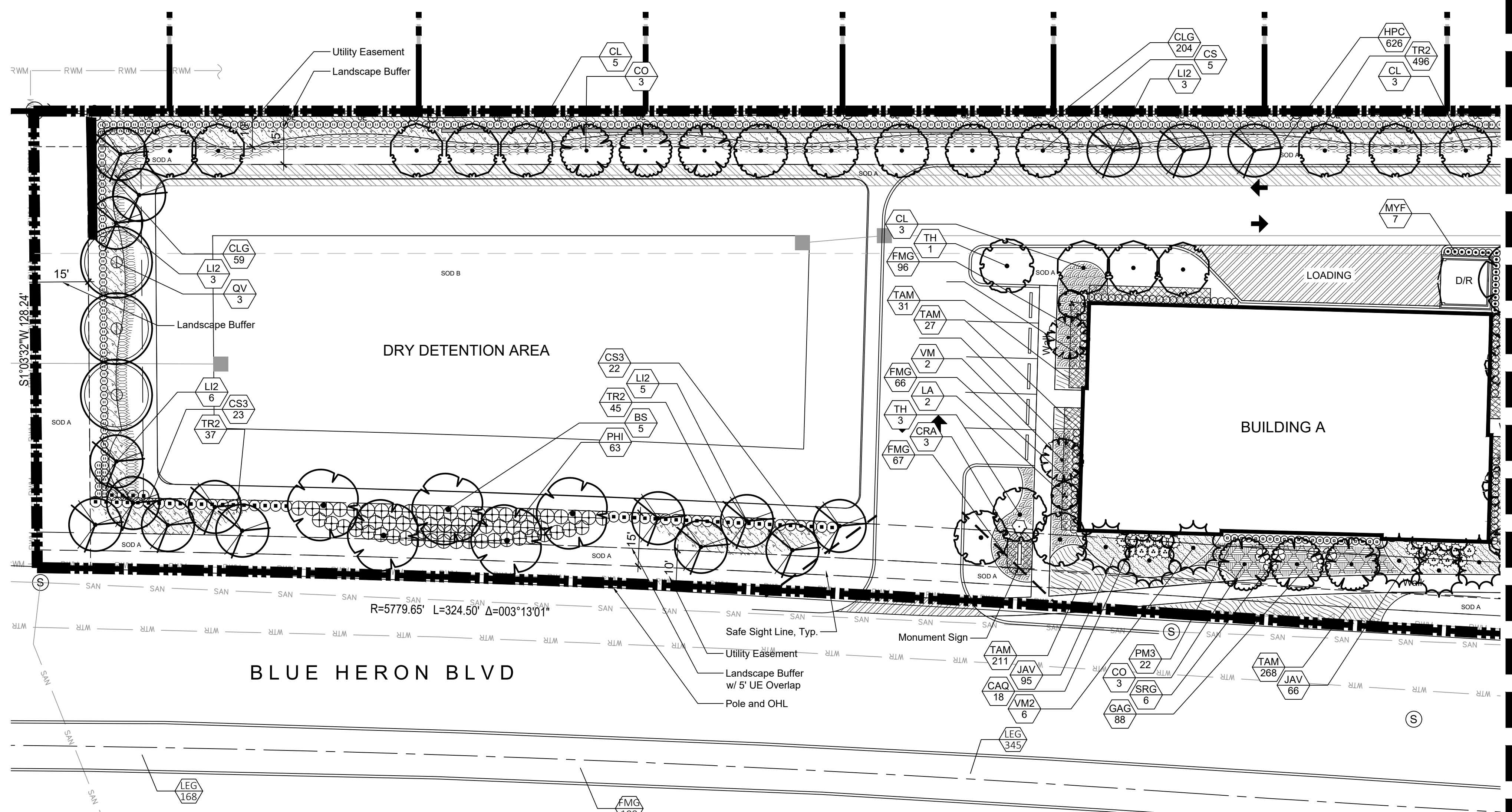

MATCHLINE A-A SHEET LP-2

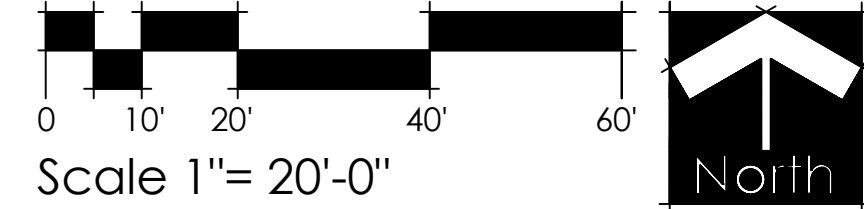

Landscape Plan