



BROTHERS' CONSTRUCTION, INC
6526 S. Kanner Hwy., #345. Stuart, Florida 34997
(772) 692-9477

LETTER OF TRANSMITTAL

December 11, 2020

Erdman Anthony
5405 Okeechobee Boulevard, Suite 200
West Palm Beach, FL 33417

Via email

Subject: Singer Island - Palm Beach Isles Bridge Improvements
City Project #18097
Submittal #025 - Existing Landscape and Tree Disposition Plan

Attention: **Ms. Phoebe Cuevas Molina, P.E.**
Associate

We are sending the following on the subject project.

No. Prints	Drawing/Spec Number	Description	Prepared By	For
1	LP-01 – LP-03 TD-01, TD-02	Existing Landscape Plan Existing Tree Disposition	Brothers' Const. Inc	Approval/Your Files

This information is being submitted to you:

Due to revisions

For Approval

Please return 1 copy "Approved" or "Approved as Noted"

Approved

For your information/files

Other

Respectfully,
BROTHERS' CONSTRUCTION, INC.

Frank Subjinski

Frank Subjinski
Vice President

PALM BEACH ISLES
SINGER ISLAND, FL. 33404
PLANTING PLAN - ISLAND DR BRIDGE

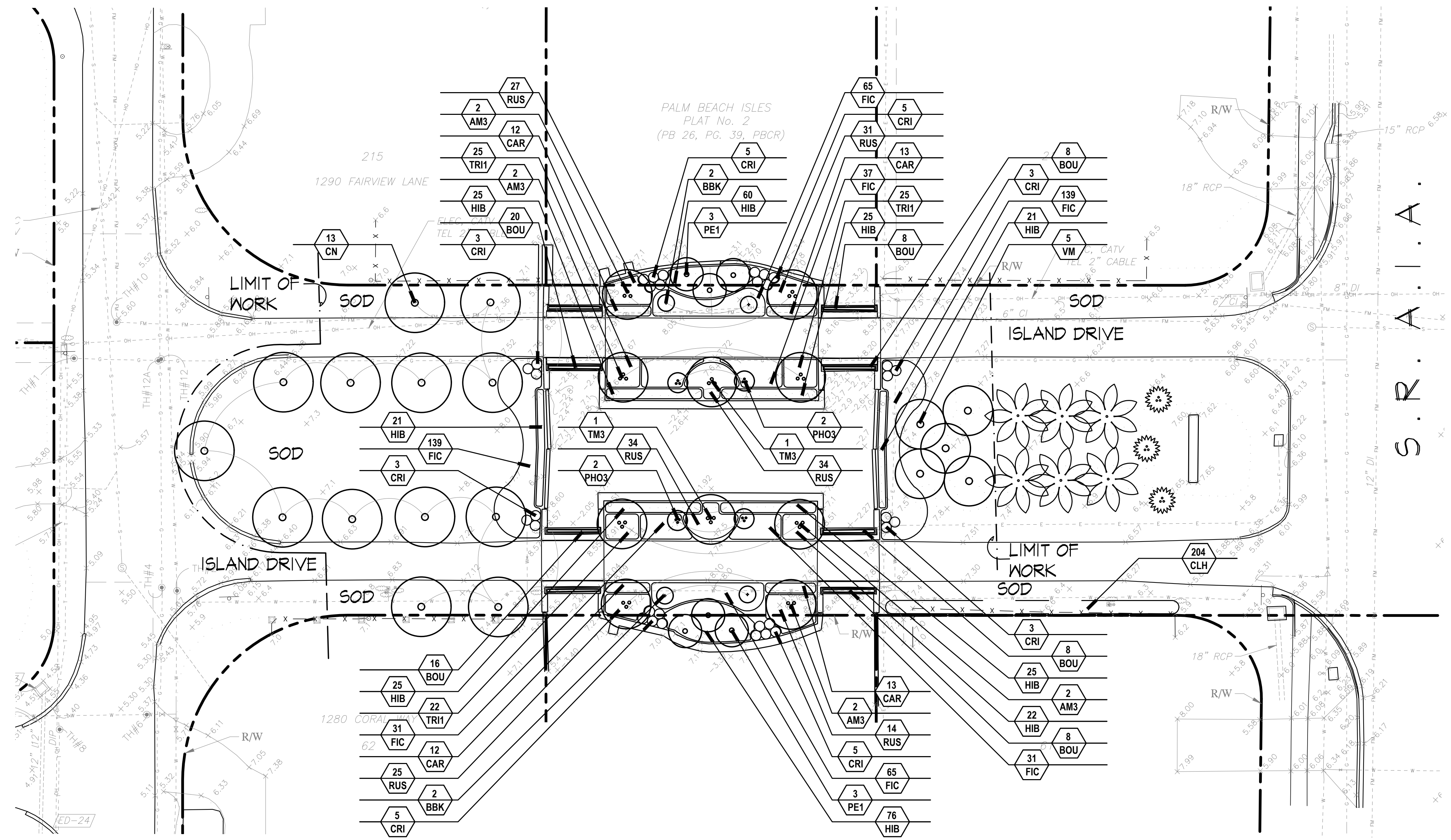

PLANT LIST						
TREES AND PALMS						
KEY	LP-1	BOTANICAL/COMMON NAME	HEIGHT	SPREAD	CLEAR TRK.	SPA. REMARKS
AM3	8	Adonidia merrillii 'Triple' Christmas Palm	12-14' o.a.			Full Canopy Triple trunk
CN	13	Cocos nucifera 'Green Malay' Green Malayan Coconut Palm	10' of wood			Stagg. ht. groups, full heads
PE1	6	Ptychosperma elegans Alexander Palm	14-16' o.a.			Stagg. ht. groups, Full canopy
TM3	2	Thrinax morrisii Key Thatch Palm	6-8' o.a.			Full Heads
VM	5	Veitchia montgomeryana Veitchia Palm	18-20' of clear trunk			Stagg. ht. groups, full heads
SHRUBS AND GROUNDCOVERS						
KEY	LP-1	BOTANICAL/COMMON NAME	HEIGHT	SPREAD	CLEAR TRK.	SPA. REMARKS
BBK	4	Bougainvillea 'Barbara Karst'	5-6'	2-3'		'Tree Standard' 'Magenta'
BOU	68	Bougainvillea 'Purple' Purple Bougainvillea	4-5' Long Runners			Trellis Grown
CAR	50	Carissa macrocarpa Natal Plum	12"	12"		2' o.c. Full cont.
CLH ^a	204	Clusia guttifera Small Leaf Clusia	5-6'			4' o.c. Full cont.
CRI	32	Crinum asiaticum Crinum Lily	30"	30"		Full clump
FIC	507	Ficus microcarpa 'Green Island' Green Island Ficus Shrub	16"	16"		2' o.c. Full cont.
HIB	300	Hibiscus rosea 'Red' Red Hibiscus Hedge	3'	20-22"		2' o.c. Full to Base
PHO3	4	Phoenix roebelinii 'Triple' Pygmy Date Palm		5-6'	3-5' of wood	Triple trunk, full heads
RUS	165	Ruellia equisetiformis Firecracker	18"	18"		2' o.c. Full cont.
TRI1 ^a	72	Tripsacum dactyloides Fakahatchee Grass	24"	24"		3' o.c. Full clump

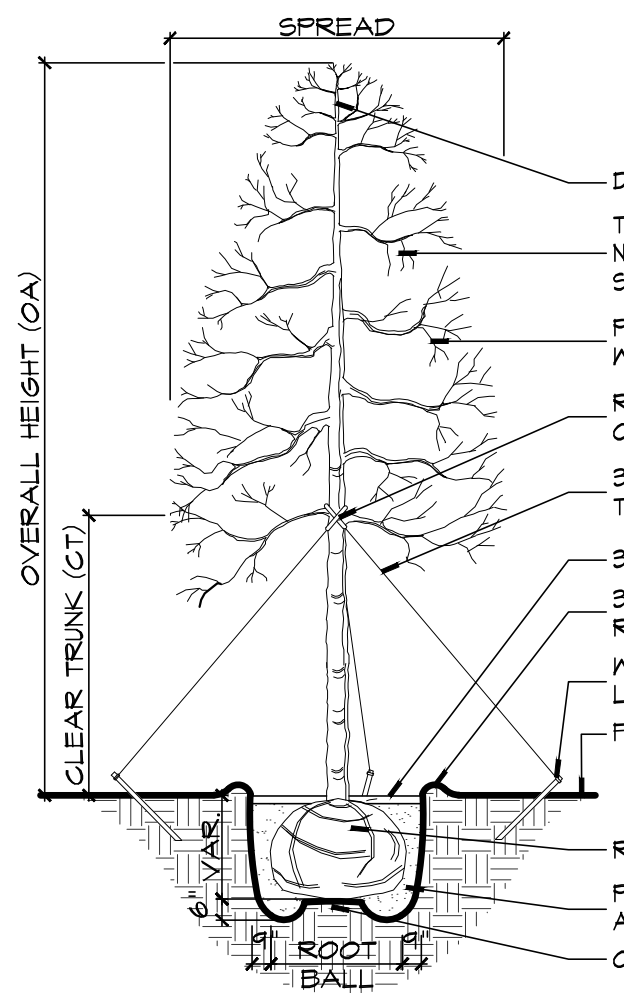

TYPICAL TREE PLANTING DETAIL

- DO NOT CUT LEADER
- THIN BRANCHES BY 25% TO RETAIN NATURAL SHAPE OF TREE. NO PRUNING SHALL BE DONE PRIOR TO INSTALLATION.
- PAINT ALL CUTS OVER 1/2" DIAMETER WITH APPROVED TREE PAINT.
- RUBBER HOSE SHALL COVER WIRE AT CROTCH OVER 1st STURDY BRANCH
- 3 DOUBLED GALV. #12 GUY WIRES, TWIST TO TIGHTEN.
- 3" LAYER OF MULCH AS SPECIFIED
- 3" HIGH WATERING SAUCER (REMOVE & REPLACE W/ SOD WHEN ESTABLISHED).
- WOOD STAKE OF SUITABLE SIZE & LENGTH TO STABILIZE TREE
- FINISH GRADE
- REMOVE BURLAP FROM TOP OF BALL
- PLANTING SOIL BACKFILL & FERTILIZER AS SPECIFIED
- COMPACT SOIL TO PREVENT SETTLEMENT

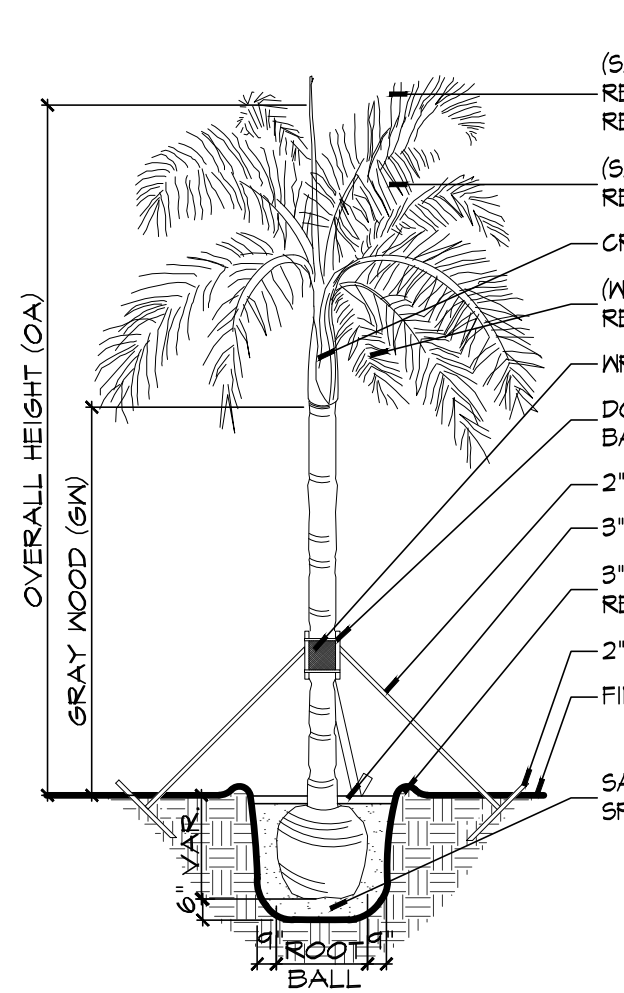

TYPICAL PALM PLANTING DETAIL

- (SABAL & WASHINGTONIA PALMS) REMOVE 1/2 OF LOWER FRONDS, THE REMAINING FRONDS TO PROTECT BID.
- (SABAL PALMS) DEAD 'BOOTS' MAY REMAIN 1-2' BELOW LIVE FRONDS.
- CROWNSHAFT ON SOME SPECIES (WASHINGTONIA PALMS) 'BEARD' TO REMAIN WHERE POSSIBLE.
- WRAP TRUNK WITH BURLAP
- DOUBLE BAND 3 MIN - 2"x4" WOOD BATTENS TO WRAPPED TRUNK
- 2"x4"x8' WOOD STAKES - 3 MIN PER TREE
- 3" LAYER OF MULCH AS SPECIFIED
- 3" HIGH WATERING SAUCER (REMOVE & REPLACE W/ SOD WHEN ESTABLISHED).
- 2"x4" WOOD STAKES
- FINISH GRADE
- SAND BACKFILL & FERTILIZER AS SPECIFIED

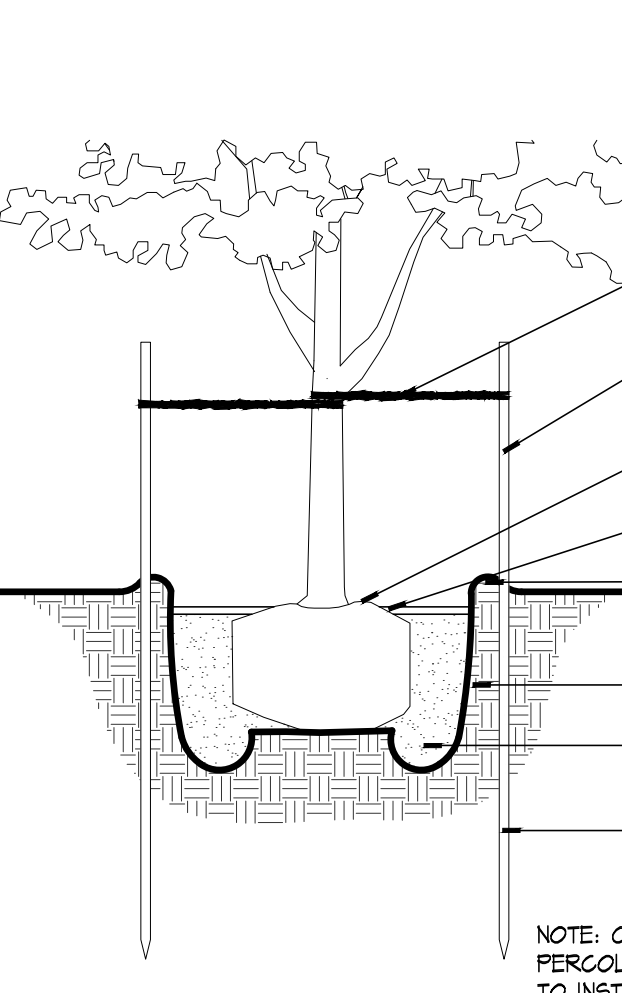

SMALL TREE PLANTING DETAIL

- ARBORITE OR APPROVED EQUAL
- 2" DIA. X 8' LONG LODGE POLE PAINTED PER LANDSCAPE NOTES
- SET TOP OF ROOT BALL 2" ABOVE FINISH GRADE
- 3" MULCH MIN. (TYP.)
- 3" HIGH WATERING SAUCER (REMOVE & REPLACE WITH SOD WHEN ESTABLISHED).
- COMPACTED SUBGRADE
- PREPARED PLANTING SOIL AS SPECIFIED
- LODGE POLES TO EXTEND 2" INTO UNDISTURBED SOIL
- NOTE: CONTRACTOR SHALL ASSURE PERCOLATION OF ALL PLANTING PITS PRIOR TO INSTALLATION

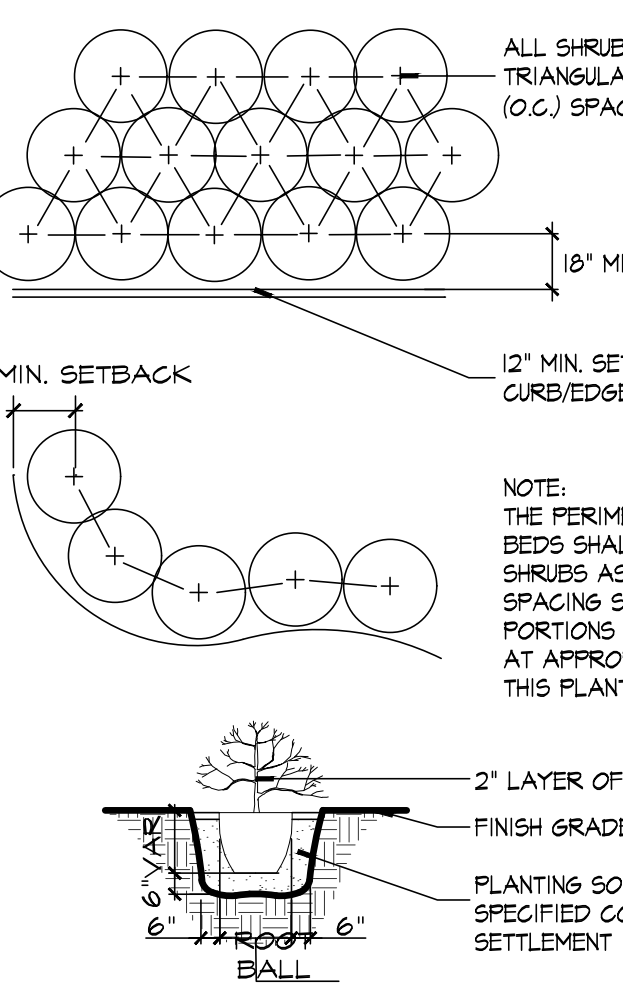

TYPICAL SHRUB PLANTING DETAIL

- ALL SHRUBS/GROUNDCOVERS TO BE TRIANGULAR SPACING. SEE PLANT LIST FOR (O.C.) SPACING
- 16" MIN. SETBACK FOR SHRUBS
- 12" MIN. SETBACK FOR GROUNDCOVERS CURB/EDGE OF PAVEMENT/BED LINE
- NOTE: THE PERIMETER OF ALL CURVED PLANTING BEDS SHALL BE PLANTED WITH A ROW OF SHRUBS AS SHOWN IN THE PLANS AND AT THE SPACING SHOWN IN THE PLANT LIST. INTERIOR PORTIONS OF EACH BED SHALL BE PLANTED AT APPROPRIATE SPACING ACCORDING TO THIS PLANT SPACING DETAIL.
- 2" LAYER OF MULCH AS SPECIFIED
- FINISH GRADE
- PLANTING SOIL BACKFILL & FERTILIZER AS SPECIFIED
- COMPACT SOIL TO PREVENT SETTLEMENT

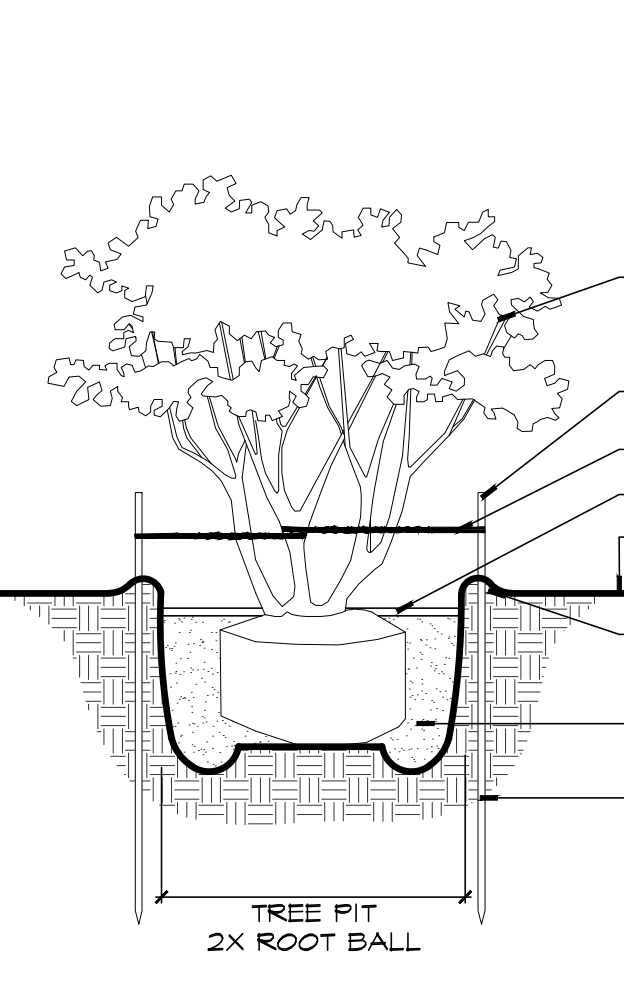

MULTI TRUNK TREE PLANTING DETAIL

- PAINT ALL CUTS OVER 1/2" DIAMETER WITH APPROVED TREE PAINT.
- 2" LODGE POLE - 2 MIN PER TREE
- ARBOR TIE OR APPROVED EQUAL
- 3" LAYER OF MULCH AS SPECIFIED
- FINISH GRADE
- 3" HIGH WATERING SAUCER (REMOVE & REPLACE W/ SOD WHEN ESTABLISHED).
- PREPARE PLANTING SOIL AS SPECIFIED
- LODGE POLES TO EXTEND 2" INTO UNDISTURBED SOIL

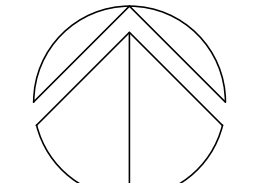

SCALE: 1" = 20'-0"

REVISIONS:
11-23-20 Revision

OCTOBER 29, 2020
DATE
M.S.
DRAWN BY:
M.J.
APPROVED BY:

This drawing is the property of Design Studio Boca, and is an instrument of service not to be reproduced in whole or in part without the express written permission of same.

LP-01

PERMIT PLANS

PALM BEACH ISLES
SINGER ISLAND, FL. 33404
PLANTING PLAN - BAHAMA LN BRIDGE

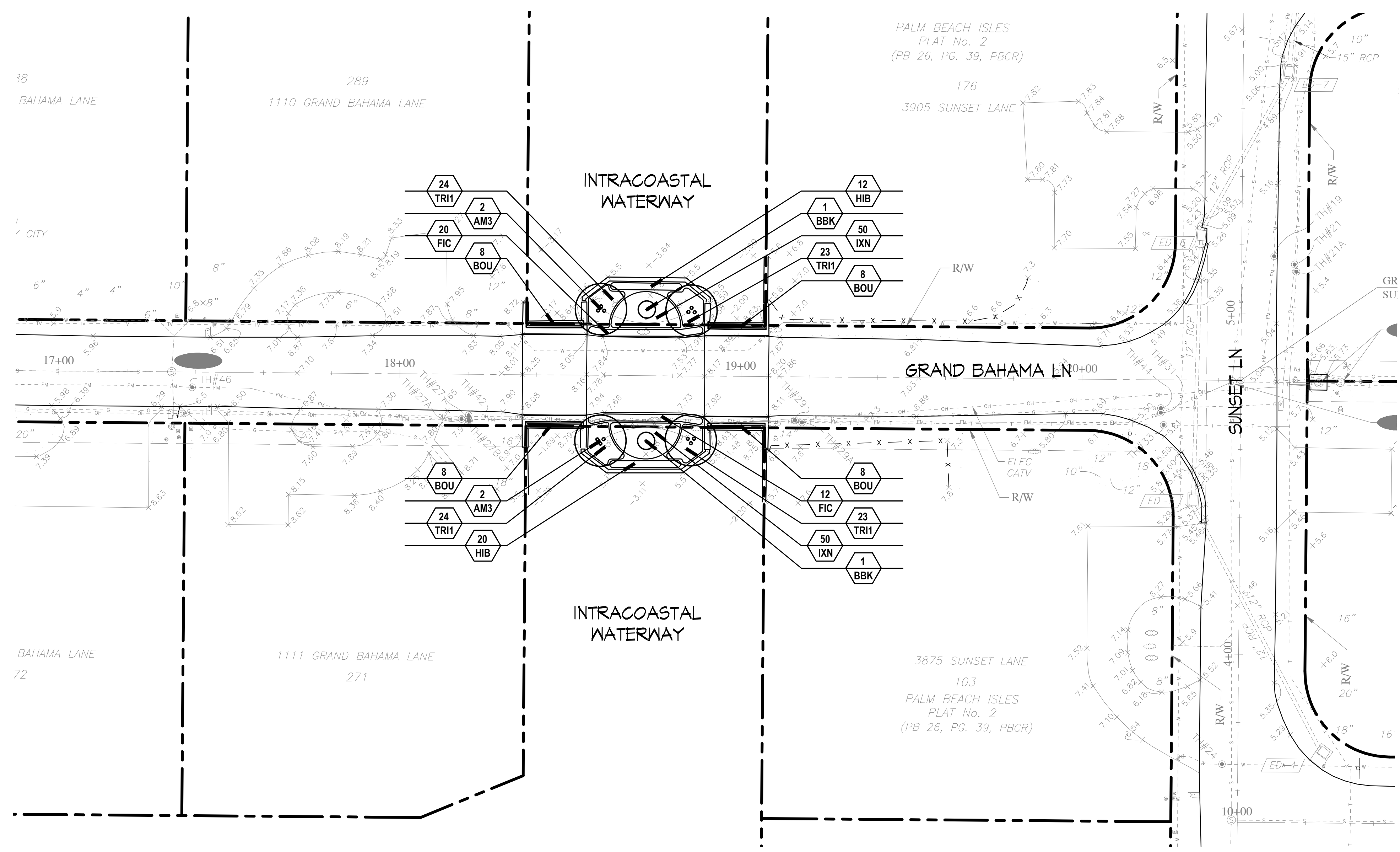

PLANT LIST							
TREES AND PALMS							
KEY	LP-2	BOTANICAL/COMMON NAME	HEIGHT	SPREAD	CLEAR TRK.	SPA.	REMARKS
AM3	4	Adonidia merrillii 'Triple' Christmas Palm	12-14' o.a.				Full Canopy Triple trunk
SHRUBS AND GROUNDCOVERS							
KEY	LP-2	BOTANICAL/COMMON NAME	HEIGHT	SPREAD	CLEAR TRK.	SPA.	REMARKS
BBK	2	Bougainvillea 'Barbara Karst'	5-6'	2-3'			Tree Standard 'Magenta'
BOU	32	Bougainvillea 'Purple'	4-5' Long Runners				Trellis Grown
FIC	32	Ficus microcarpa 'Green Island'	16"	16"		2' o.c.	Full cont.
HIB	32	Hibiscus rosea 'Red' Red Hibiscus Hedge	3'	20-22"		2' o.c.	Full to Base
IXN	100	Ixora 'Nora Grant' Pink Ixora	2'	20-22"		2' o.c.	Full cont.
TRI1*	94	Tripsacum dactyloides Fakahatchee Grass	24"	24"		3' o.c.	Full clump

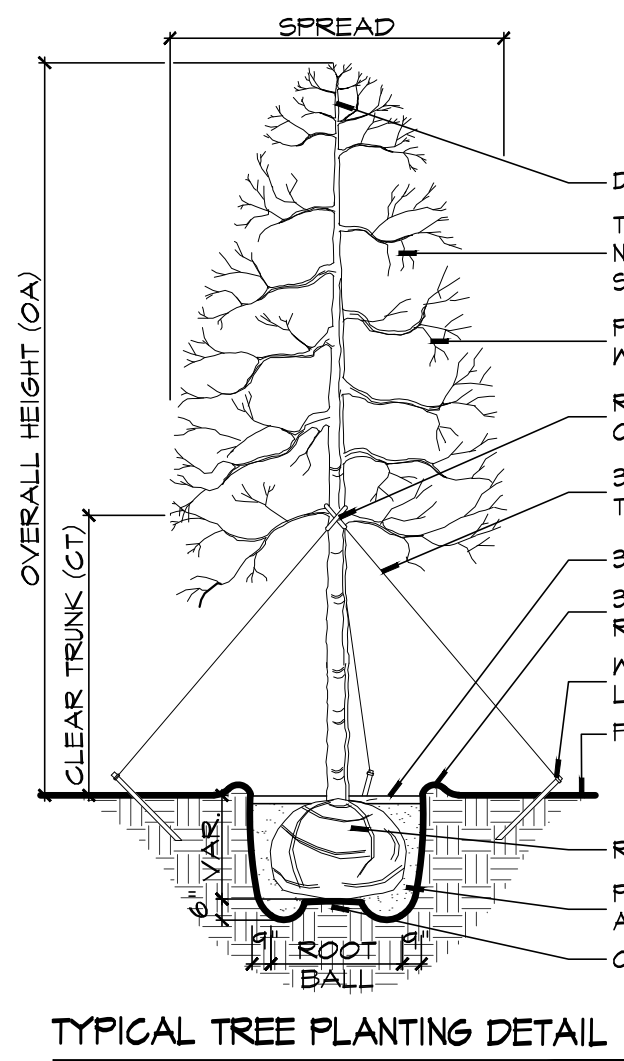

DO NOT CUT LEADER
THIN BRANCHES BY 25% TO RETAIN NATURAL SHAPE OF TREE. NO PRUNING SHALL BE DONE PRIOR TO INSTALLATION.
PAINT ALL CUTS OVER 1/2" DIAMETER WITH APPROVED TREE PAINT.
RUBBER HOSE SHALL COVER WIRE AT CROTCH OVER 1st STURDY BRANCH
3 DOUBLED GALV. #12 GUY WIRES, TWIST TO TIGHTEN.
3" LAYER OF MULCH AS SPECIFIED
3" HIGH WATERING SAUCER (REMOVE & REPLACE W/ SOD WHEN ESTABLISHED).
WOOD STAKE OF SUITABLE SIZE & LENGTH TO STABILIZE TREE
FINISH GRADE
REMOVE BURLAP FROM TOP OF BALL
PLANTING SOIL BACKFILL & FERTILIZER AS SPECIFIED
COMPACT SOIL TO PREVENT SETTLEMENT

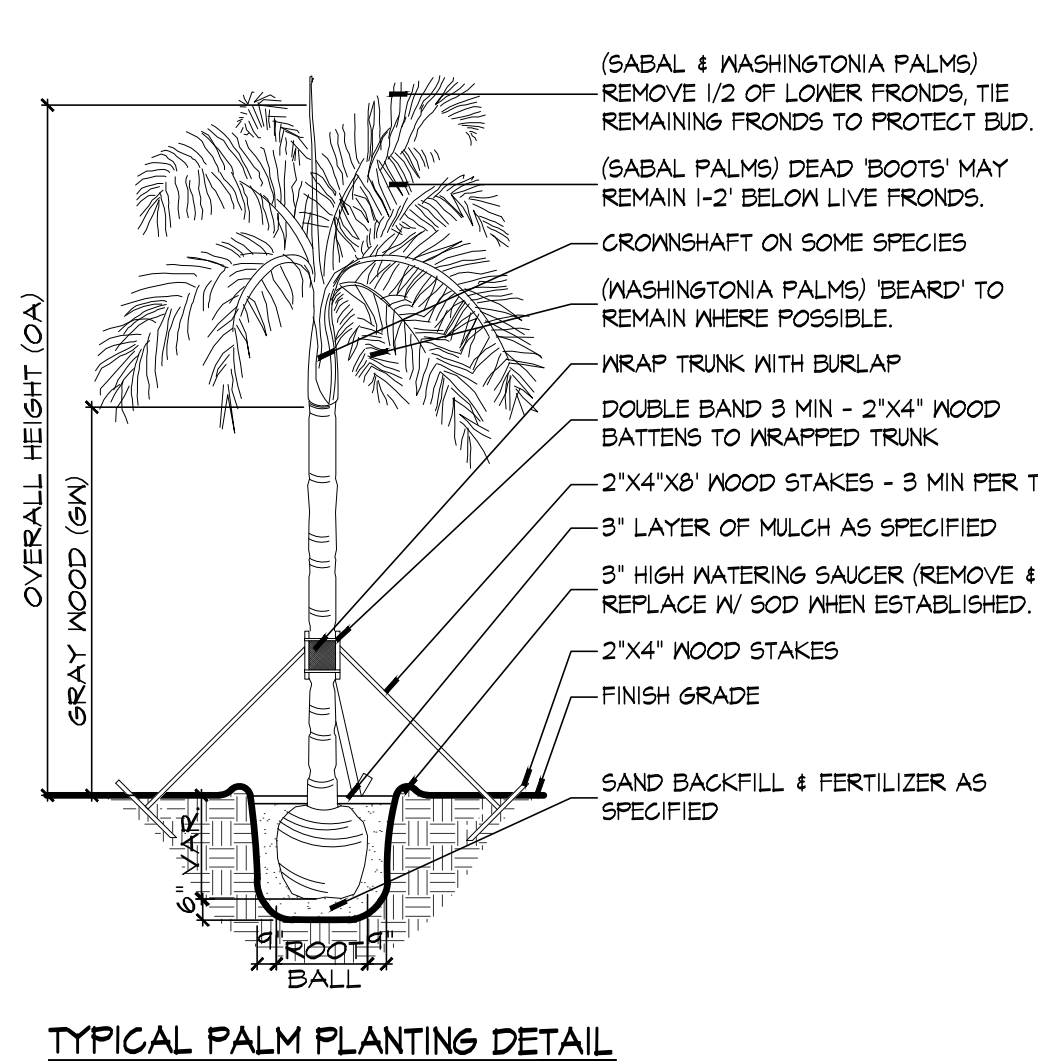

(SABAL & WASHINGTONIA PALMS) REMOVE 1/2 OF LOWER FRONDS, THE REMAINING FRONDS TO PROTECT BUD.
(SABAL PALMS) DEAD 'BOOTS' MAY REMAIN 1-2' BELOW LIVE FRONDS.
CROWNSHAFT ON SOME SPECIES (WASHINGTONIA PALMS) 'BEARD' TO REMAIN WHERE POSSIBLE.
WRAP TRUNK WITH BURLAP
DOUBLE BAND 3/8" - 2"x4" WOOD BATTENS TO WRAPPED TRUNK
2"x4"x8" WOOD STAKES - 3 MIN PER TREE
3" LAYER OF MULCH AS SPECIFIED
3" HIGH WATERING SAUCER (REMOVE & REPLACE W/ SOD WHEN ESTABLISHED).
2"x4" WOOD STAKES
FINISH GRADE
SAND BACKFILL & FERTILIZER AS SPECIFIED

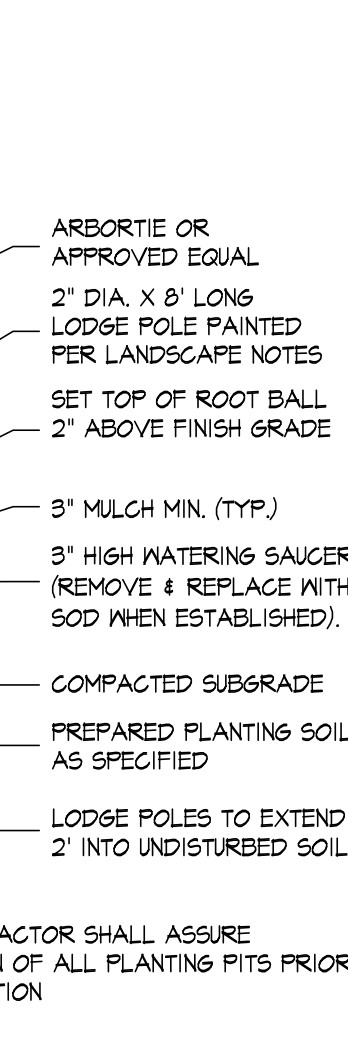

ARBORET OR APPROVED EQUAL
2" DIA. X 8' LONG LODGE POLE PAINTED PER LANDSCAPE NOTES
SET TOP OF ROOT BALL 2" ABOVE FINISH GRADE
3" MULCH MIN. (TYP.)
3" HIGH WATERING SAUCER (REMOVE & REPLACE WITH SOD WHEN ESTABLISHED).
COMPACTED SUBGRADE
PREPARED PLANTING SOIL AS SPECIFIED
LODGE POLES TO EXTEND 2" INTO UNDISTURBED SOIL
NOTE: CONTRACTOR SHALL ASSURE PERCOLATION OF ALL PLANTING PITS PRIOR TO INSTALLATION

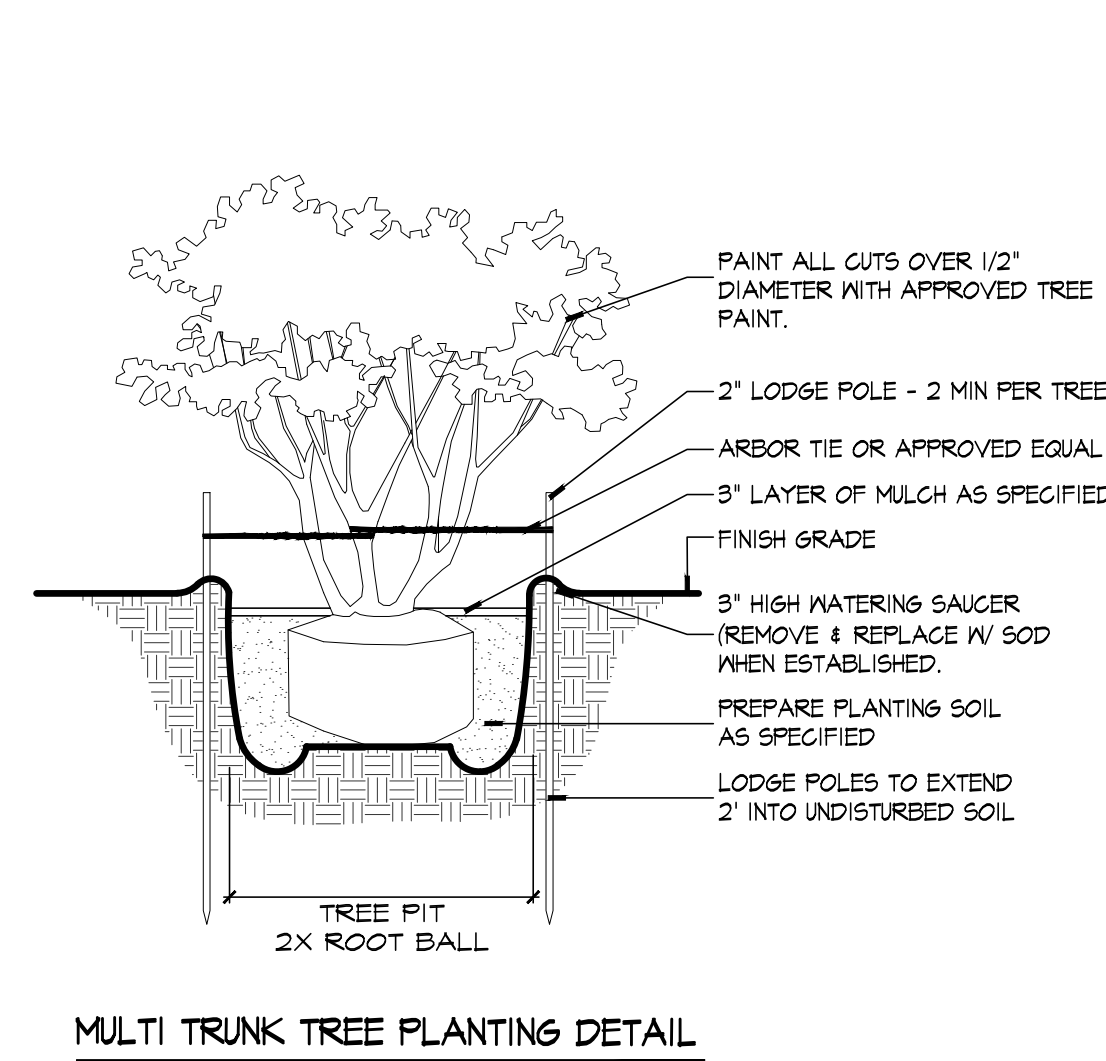

ALL SHRUBS/GROUNDCOVERS TO BE TRIANGULAR SPACING. SEE PLANT LIST FOR (O.C.) SPACING
16" MIN. SETBACK FOR SHRUBS
12" MIN. SETBACK FOR GROUNDCOVERS CURB/EDGE OF PAVEMENT/BED LINE
NOTE: THE PERIMETER OF ALL CURVED PLANTING BEDS SHALL BE PLANTED WITH A ROW OF SHRUBS AS SHOWN IN THE PLANS AND AT THE SPACING SHOWN IN THE PLANT LIST. INTERIOR PORTIONS OF EACH BED SHALL BE PLANTED AT APPROPRIATE SPACING ACCORDING TO THIS PLANT SPACING DETAIL.
2" LAYER OF MULCH AS SPECIFIED
FINISH GRADE
PLANTING SOIL BACKFILL & FERTILIZER AS SPECIFIED
COMPACT SOIL TO PREVENT SETTLEMENT

REVISIONS:

11-23-20	Revision

OCTOBER 29, 2020
DATE
M.S.
DRAWN BY:
M.J.
APPROVED BY:

This drawing is the property of Design Studio Boca, and is an instrument of service not to be reproduced in whole or in part without the express written permission of same.

SCALE: 1" = 20'-0"

GENERAL PLANTING SPECIFICATIONS:

1. Scope:

The work includes furnishing all plants, materials, equipment and labor necessary for planting of plant materials indicated on the drawings and in these specifications. A list of plants is attached to these specifications.

2. Plant Materials & Protection:

- A. All plant materials shall be nursery grown unless otherwise noted.
- Spread (or Spr.): Indicates average spread to midpoint of current season's growth.
- Height (or O.A.): Indicates overall height from top of ball to midpoint of current season's growth.
- C.T.: Indicates clear trunk measurement from top of ball to first branching (see tree & Palm Planting Diagram)
- Meter of Wood (or Meter of Hard Grey Wood): Indicates measurement of Palms from top of ball to top of solid trunk before start of frond stalks or green 'boots'. (See Palm Planting Diagram)
B. Quantities: All quantities indicated on the plant list are intended as a guide for the bidders and does not relieve the bidder of his responsibility to do a comprehensive plant take off.
C. Quality and Sizes: Plants shall have a habit of growth that is normal for the species and shall be healthy, vigorous and equal or exceed the measurements specified in the plant list...

D. Substitution: Plant substitution requests by the Contractor will be considered by the Architect/Landscape Architect only upon submission of proof that any plant is not obtainable in the type or size specified.

E. Protection of Plants:

- 1. Root Protection
A. Balled and Burlapped Plants (B & B) shall be dug with natural balls of earth of sufficient diameter and depth to encompass the fibrous and feeding root system necessary for full recovery of the plant.
B. Container Grown Plants: Plants grown in containers will be accepted as B & B, providing that all other specified requirements are met.
2. Protection During Transporting: All plants transported by open trucks shall be adequately covered to prevent windburn, drying or damage to plants.
3. Protection After Delivery: Plants which cannot be planted immediately upon delivery to the site shall be covered with moist soil, mulch, or other protection from the drying of wind and sun.
4. Protection of Palms: Only a minimum of fronds shall be removed from the crown of the palm trees to facilitate moving and handling.
5. Protection During Planting: Trees moved by winch or crane shall be thoroughly protected from chain marks, girdling or bark slippage by means of other approved methods.

3. Materials:

- A. Commercial Fertilizer: Commercial fertilizer shall be organic fertilizer containing nitrogen, phosphoric acid and potash in equal percentages, 6-6-6 with micro nutrients.
Nitrogen shall be not less than 50 % from organic source. Inorganic chemical nitrogen shall not be derived from the sodium form of nitrate.
B. Peat: Peat shall be horticultural peat composed of not less than 60% decomposed organic matter by weight, on an oven dried basis.
C. Planting Soil: Planting soil for all plantings shall be sandy loam and shall contain a 25% minimum amount of decomposed organic matter.
D. Mulch: Mulch material to be shredded "dark brown" hybrid mulch B grade or better, moistened at time of installation to prevent wind displacement.
E. Drainage Stone (when applicable): Drainage stone shall be gravel or crushed stone reasonably free of sharp edges - 1/2"-1 1/4" in diameter - as required in the bottom of raised planters.
F. Filter Fabric: (when applicable): Filter fabric, as required between gravel and soil in planters to be Dewitt "Filter-Fabric" (800)888-9669 or equal.

4. Planting Operations:

- A. Soil Preparation: All existing soil and new fill/biems shall be treated with an approved weed killer such as "Round Up" according to manufacturer's specifications.
B. Layout: Location for plants and outlines of areas to be planted are indicated on the drawings. All plant locations shall be staked in the field by the Contractor, to the satisfaction of the Architect/Landscape Architect.
C. Excavation for Planting: Excavation of holes shall extend to the required sub-grades as specified hereunder. Plant pits shall be circular in outline and shall have a profile which conforms to the "Typical Tree & Palm Planting Details"(attached).
D. Balled and Burlapped Plants: After final setting, loosen wrappings of balled and burlapped plants and roll wrappings back from top of ball, leaving ball unbroken.
E. Container Grown Plants: Container grown plants shall, when delivered, have sufficient root growth to hold earth intact when removed from container.
F. Pit Sizes: Minimum diameter (Width) and depth of planting pits for balled and burlapped, and container grown plants shall be as follows:
-Diameter-Trees: 18" greater than diameter of ball or spread of roots.
-Diameter-Shrubs: 6" greater than diameter of ball or spread of roots.
-Depth-Trees and Shrubs: 4" greater than depth of ball or roots to provide 4" of topsoil backfill under the root ball.
G. Backfilling: When pit has been excavated as specified in Paragraph IV-C, the pit shall be backfilled with material as specified in Paragraph III. A, B, C, D, and IV. B and shown in the Typical Tree and Shrub diagrams (attached).
H. Setting Trees and Shrubs: Unless otherwise specified, all trees and shrubs shall be planted in pits, centered and set on four inches (4") of compacted topsoil to such depths that the finished grade level of the plant after settlement shall be the same as that at which the plant was grown.
I. Setting Palms: All palms shall be planted in sand, thoroughly washed in during planting operations and with a shallow saucer depression left at the soil line for future waterings.
J. Pruning - New Plant Material: Remove dead and broken branches from all plant material. Prune to retain typical growth habit of individual plants with as much height and spread as is practicable.
K. Guying Tree: (See "Typical Tree Planting Diagram" included herein.) Guy all trees 1 1/2 inches in caliper and greater, in three directions with two strands of No. 12 galvanized wire attached to approved anchors driven below grade.
L. Mulching: All trees and shrub beds shall be mulched immediately after planting to a two inch (2") depth.
M. Excess Excavated Soil: Excess excavated soil shall be disposed of by the Contractor at no additional expense to the Owner, at Owner's discretion.
N. Relocated Material (when applicable): Existing material shown on the plan to be relocated shall be root-pruned as far ahead of time as necessary to move them safely, and shall be protected and treated as new material, as previously specified.
O. Disposition of Existing Material: All existing plant material not shown as remaining or relocated shall be removed from the site at no additional cost to the Owner, at Owner's discretion.

5. Sod

- A. Soil: The Landscape Contractor shall submit a unit price per cubic yard for the supply and distribution of planting soil as herein before specified, to be applied at a depth of one inch (1"), to all areas receiving sod.
B. Grades: It shall be the responsibility of the Landscape Contractor to finish (fine) grade all landscape areas, eliminating all bumps, depressions, sticks, stones and other debris to the satisfaction of the Architect/Landscape Architect.
C. The sod shall be as called for on the landscape plans. Sod shall be of firm tough texture, having a compact growth of grass with good root development, and shall contain no weeds or any other objectionable vegetation.
D. Before being cut and lifted, the sod shall have been mowed at least three times with a lawn mower, with the final mowing not more than seven days before the sod is cut.
E. Solid sod shall be laid with closely abutting joints with a tamped or rolled, even surface. It shall be the responsibility of the Contractor to bring the sod edge in a neat, clean manner to the edge of all paving and shrub areas.

6. Clean-up:

Any soil, peat or similar material which has been brought onto any paved areas shall be removed promptly, keeping these areas clean as the work progresses. Upon completion of the planting, all excess soil, stones and debris which has not been previously cleaned up shall be removed from the site or disposed of as directed by the Architect/Landscape Architect.

7. Maintenance:

- A. Maintenance shall begin immediately after each plant is planted and shall continue until all planting has passed final inspection and acceptance by the Owner.
B. The Contractor shall deep-water all trees and shrubs for a period of ninety (90) days after planting. In the event an irrigation system is operable, Contractor shall see that adequate water is supplied for that period.

8. Inspection and Acceptance:

- A. Inspection: Inspection of work to determine completion of contract, exclusive of the possible replacement of plants, will be made by the Owner and/or Landscape Architect at the conclusion of all planting and at the written request of the Contractor.
B. Acceptance: After inspection, the Contractor will be notified by the Owner of the acceptance of all plant material and workmanship, exclusive of the possible replacement of plants subject to guarantee.

9. Guarantee and Replacement:

- A. Guarantee: The Contractor shall furnish a written guarantee warranting all materials, workmanship and plant materials, for a period specified in the General Conditions of Project Specifications.
B. Replacement: During guarantee period, any plant required under this contract that is dead or not in satisfactory condition, as determined by the Architect/Landscape Architect, shall be replaced within two weeks of notification by the Architect/Landscape Architect.
C. Material and Operations: All replacements shall be plants of the same kind and size as specified in the plant list. They shall be furnished and planted as specified herein.

10. Care and Maintenance Schedule:

- A. The Contractor shall furnish the Owner's Maintenance staff with a written and detailed description for the care and maintenance of all plant materials and irrigation systems at the time of final inspection. Contractor will also provide a one year Landscape Maintenance Contract, to take affect after substantial completion of the project.

11. Permits and Regulations:

- A. The Contractor shall give all notices and comply with all laws, ordinances, rules and regulations bearing on the conduct of this work as drawn and specified.

12. Protection of Work and Property:

- A. The Contractor shall continuously maintain adequate protection of all his work from damage and theft, and shall protect the Owner's property from injury and loss arising in connection with this contract, making good any such loss or injury or damage except where caused by Owner or his agents.
B. The Contractor shall provide protection for existing trees and other plant material as designated by drawings, by Owner's representative or by local authorities.
C. A competent superintendent, foreman or workman capable of reading drawings and acting on behalf of the Contractor shall be kept on the work during its progress.

13. Changes In The Work:

- A. The Contractor shall conduct a soil survey of the site to determine the need for any additives to overcome severe conditions not met by normal planting soil requirements.
B. The Contractor shall advise the Owner and Landscape Architect of any special site conditions (high water table, light or soil conditions, etc.) that might require change of plant material or adjustment to finish elevation shown.

14. Landscape Architect:

- A. The Landscape Architect is the author of the design and agents for its execution. When his services are used by the Owner for supervision, he shall act impartially between the Owner and Contractor and shall have authority to reject all work and materials which do not conform to the contract.
B. The Contractor shall remove from the site all materials considered not up to specifications by the Landscape Architect and replace with suitable materials.

15. Obstructions:

- A. The Contractor shall acquaint himself with the existence and location of all surface and subsurface structures, utilities and installations before commencing any work, and shall avoid any disturbance or damage to them throughout the course of the work. Repairs to any utilities, subsurface structures and installations and surface obstructions damaged by the Contractor shall be at the Contractor's own time and expense.

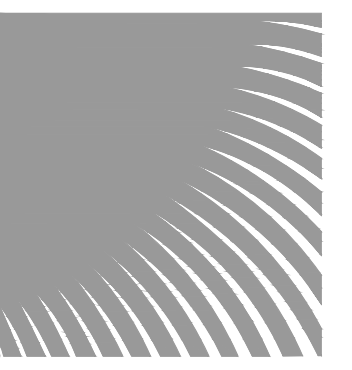

DSBOCA design studio boca

landscape architects and planners

LC - 0000396
2300 Corporate Blvd. NW, Suite 214
Boca Raton, Florida 33431
Ph. 561.955.8623
Fax. 561.362.4749

email: landscaperchitects@dsboca.com

PALM BEACH ISLES
SINGER ISLAND, FL. 33404
PLANTING SPECIFICATIONS

Table with 2 columns: REVISIONS, 11-23-20 Revision

OCTOBER 29, 2020
DATE
M.S.
DRAWN BY:
M.J.
APPROVED BY:

This drawing is the property of Design Studio Boca, and is an instrument of service not to be reproduced in whole or in part without the express written permission of same.

LP-03

PERMIT PLANS



KEY MAP
N.T.S.

TREE DISPOSITION PLAN

NUMBER	COMMON NAME	BOTANICAL NAME	DBH	HEIGHT	SPREAD	CONDITION	DISPOSITION	REMARKS
1	Coconut Palm	Cocos nucifera		25'	20'		Remove	
2	Coconut Palm	Cocos nucifera		25'	20'		Remove	
3	Coconut Palm	Cocos nucifera		20'	15'		Remove	
4	Coconut Palm	Cocos nucifera		20'	15'		Remove	
5	Coconut Palm	Cocos nucifera		20'	15'		Remove	
6	Sabal Palm	Sabal palmetto		20'	15'		Remove	
7	Sabal Palm	Sabal palmetto		15'	15'		Remove	
8	Christmas Palm	Adonidia merrillii		15'	8'		Remove	Double
9	Alexander Palm	Ptychosperm elegans		15'	8'		Remove	Double
10	Alexander Palm	Ptychosperm elegans		8'	6'		Remove	
11	Alexander Palm	Ptychosperm elegans		10'	6'		Remove	
12	Key Thatch Palm	Thrinax morrisii		15'	10'		Remove	Triple
13	Sabal Palm	Sabal palmetto		18'	15'		Remove	
14	Sabal Palm	Sabal palmetto		25'	18'		Remove	
15	Christmas Palm	Adonidia merrillii		15'	8'		Remove	Triple
16	Seagrape	Coccoloba uvifera		15'	15'		Remove	
17	Veitchia Palm	Veitchia montgomeryana		30'	15'		Remove	
18	Veitchia Palm	Veitchia montgomeryana		30'	15'		Remove	
19	Veitchia Palm	Veitchia montgomeryana		30'	15'		Remove	
20	Royal Palm	Roystonea elata		25'	18'		Remain	
21	Royal Palm	Roystonea elata		25'	18'		Remain	
22	Royal Palm	Roystonea elata		25'	18'		Remain	
23	Christmas Palm	Adonidia merrillii		15'	10'		Remain	
24	Coconut Palm	Cocos nucifera		18'	15'		Remove	
25	Coconut Palm	Cocos nucifera		20'	15'		Remove	
26	Coconut Palm	Cocos nucifera		20'	15'		Remove	
27	Coconut Palm	Cocos nucifera		20'	15'		Remove	
28	Christmas Palm	Adonidia merrillii		15'	8'		Remove	Triple
29	Sabal Palm	Sabal palmetto		10'	10'		Remove	
30	Coconut Palm	Cocos nucifera		20'	15'		Remove	
31	Coconut Palm	Cocos nucifera		20'	15'		Remove	
32	Alexander Palm	Ptychosperm elegans		15'	6'		Remove	Double
34	Alexander Palm	Ptychosperm elegans		15'	6'		Remove	Double
36	Christmas Palm	Adonidia merrillii		15'	8'		Remove	Triple
38	Key Thatch Palm	Thrinax morrisii		15'	10'		Remove	Double
39	Veitchia Palm	Veitchia montgomeryana		30'	15'		Remove	
40	Coconut Palm	Cocos nucifera		25'	18'		Remove	
41	Veitchia Palm	Veitchia montgomeryana		30'	15'		Remove	
42	Christmas Palm	Adonidia merrillii		15'	10'		Remain	Triple
43	Christmas Palm	Adonidia merrillii		15'	10'		Remain	Triple
44	Royal Palm	Roystonea elata		25'	18'		Remain	
45	Royal Palm	Roystonea elata		25'	18'		Remain	
46	Royal Palm	Roystonea elata		25'	18'		Remain	
47	Coconut Palm	Cocos nucifera		25'	18'		Remove	

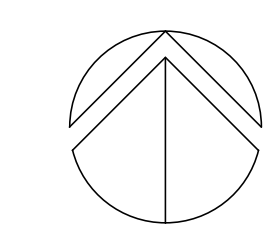

SCALE: 1" = 20'



landscape architects
and planners
LC - 0000396
2300 Corporate Blvd. NW, Suite 214
Boca Raton, Florida 33431
Ph. 561.955.8623
Fax: 561.362.4749
email: landscaperchitects@dsboca.com

PALM BEACH ISLES
SINGER ISLAND, FL. 33404
TREE DISPOSITION PLAN - ENTRANCE BRIDGE

REVISIONS:

11-23-20	Revision

OCTOBER 29, 2020
DATE
M.S.
DRAWN BY:
M.J.
APPROVED BY:

This drawing is the property of Design Studio Boca, and is an instrument of service not to be reproduced in whole or in part without the express written permission of same.

TD-01

PERMIT
PLANS

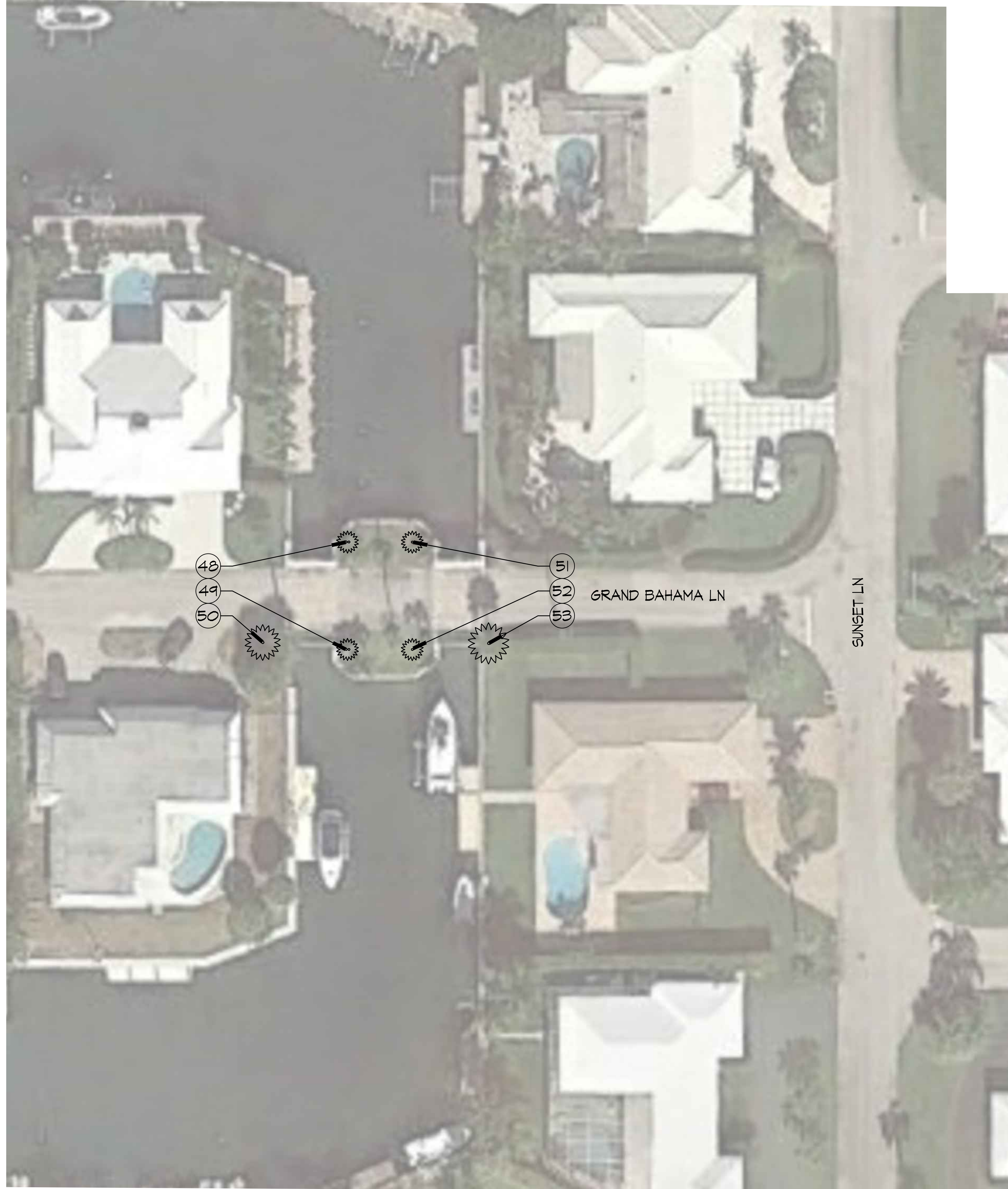

KEY MAP
N.T.S.

TREE DISPOSITION PLAN

NUMBER	COMMON NAME	BOTANICAL NAME	DBH	HEIGHT	SPREAD	CONDITION	DISPOSITION	REMARKS
48	Christmas Palm	Adonidia merrillii		15'	8'		Remove	Double
49	Christmas Palm	Adonidia merrillii		15'	8'		Remove	Double
50	Sabal Palm	Sabal palmetto		15'	13'		Remove	
51	Christmas Palm	Adonidia merrillii		15'	8'		Remove	
52	Christmas Palm	Adonidia merrillii		15'	8'		Remove	
53	Sabal Palm	Sabal palmetto		25'	15'		Remove	

PALM BEACH ISLES
SINGER ISLAND, FL. 33404
TREE DISPOSITION PLAN - WEST BRIDGE

REVISIONS:
11-23-20 Revision

OCTOBER 29, 2020
DATE

M.S.
DRAWN BY:

M.J.
APPROVED BY:

This drawing is the property of Design Studio Boca, and is an instrument of service not to be reproduced in whole or in part without the express written permission of same.

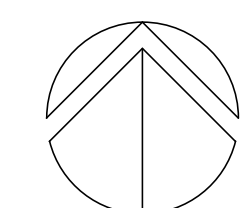

SCALE: 1" = 20'

TD-02

PERMIT
PLANS